

MSA Latchways® Vertical Ladder Lifeline Kits

Vertical
ladder lifeline

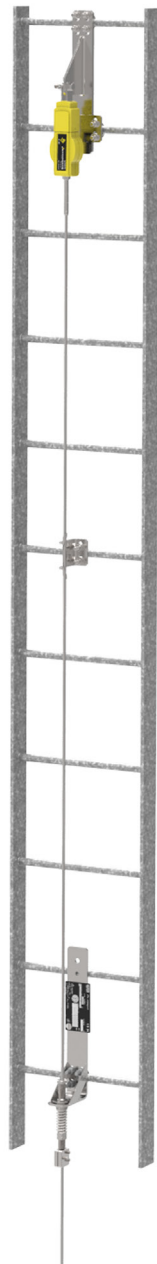

Vertical ladder
lifeline with
extension post



WE KNOW WHAT'S AT STAKE.

Kit Overview

MSA Latchways Vertical Ladder Lifeline Kits provide an easy-to-install solution when fall protection is necessary for climbing activities on fixed ladders. A vertical lifeline allows movement up and down the entire height of the ladder, eliminating the need to disconnect and find new tie-off points while ascending or descending a ladder. In the event of a fall, the climbing device automatically engages the vertical lifeline and locks, arresting the fall and potentially saving a life.

These vertical ladder kits come in multiple lengths for different ladder heights, can be adapted to various rung shapes and sizes and must be used in conjunction with an approved climbing device like the LadderLatch™.

The LadderLatch climbing device is a device for use on the MSA Latchways vertical lifelines with energy absorber. It incorporates the unique starwheel, allowing the unit to pass easily over cable supports while climbing without the need to detach. It also includes an anti-inversion mechanism so the device cannot be connected to the cable upside down.

The Latchways LadderLatch is **SOLD SEPARATELY**.

Extension Posts are necessary for ladders where the top rung does not give the necessary clearance required to step on to the surface area. The extension post provides additional height above the fixed ladder in order to step onto the surface area and detach safely from the lifeline.

Approvals

- EN 353-1:2018
- ANSI Z359.16
- CSA Z259.2.5
- Meets OSHA 1910.28
– Walking/Working Surfaces Standard

Ordering Information

Vertical Ladder Lifeline Kit	
Part Number	
30923-00	3m (10')
30924-00	6m (20')
30925-00	12m (40')
30906-00	19m (60')
30907-00	25m (80')
30908-00	31m (100')
30909-00	37m (120')
30910-00	43m (140')
30911-00	49m (160')
30912-00	55m (180')

Vertical Ladder Lifeline Kit (with extension post)	
Part Number	
30913-00	3m (10')
30914-00	6m (20')
30915-00	12m (40')
30916-00	19m (60')
30917-00	25m (80')
30918-00	31m (100')
30919-00	37m (120')
30920-00	43m (140')
30921-00	49m (160')
30922-00	55m (180')

Attachment device (sold separately)

Latchways attachment devices are designed to connect the user, wearing a full body harness, to a Latchways cable lifeline. These devices allow hands-free operation for system users. The unique starwheel allows the device to pass over cable supports without the need to detach from the lifeline.

LadderLatch device	
Part Number	Conformance
3100L-00T	EN 353-1:2018
3103L-00	CSA – Z259.2.5-12
3104L-00	ANSI – Z359.16-2016



Only approved climbing devices like the LadderLatch™ can be used with the MSA Latchways Vertical Ladder Lifeline Kits.

Kit Components

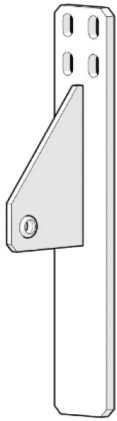

Top Anchor

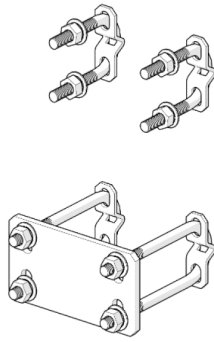

Extension Post Fixing Kit

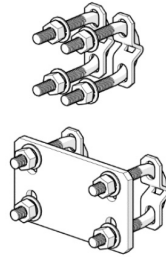

Top Anchor Fixing Kit



Energy Absorber Lifeline Assembly



Galvanised extension post

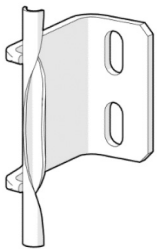

Ladder Mount
Intermediate Cable Guide

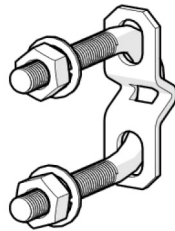

Cable Guide Fixing Kit

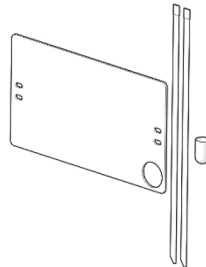

System Label Kit

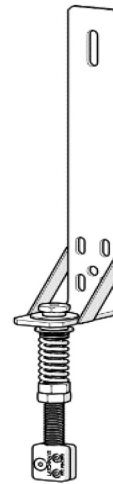

Bottom Anchor Assembly

Also included: Stainless steel cable and swageslip indicator

Kit Components

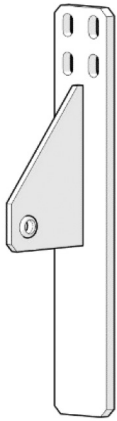

Top Anchor

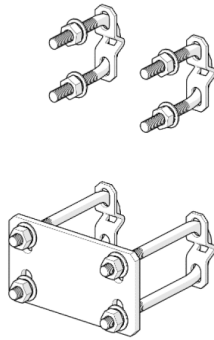

Extension Post Fixing Kit

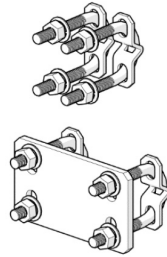

Top Anchor Fixing Kit



Energy Absorber Lifeline Assembly



Galvanised extension post

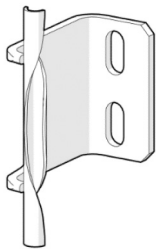

Ladder Mount
Intermediate Cable Guide

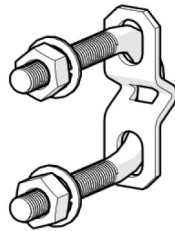

Cable Guide Fixing Kit

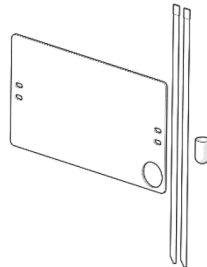

System Label Kit

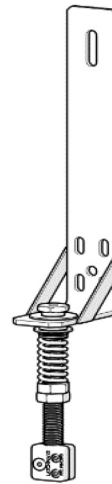

Bottom Anchor Assembly

Also included: Stainless steel cable and swageslip indicator

Tools Required

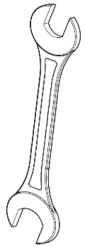

x1 (19mm)



x2 Max (30mm)

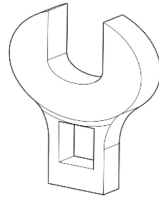

x1 (17mm)



x1 (10Nm-60Nm)



x1 (5mm)



x1 (17mm)



x1 (19mm)



x1

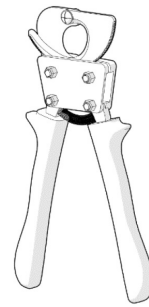

x1

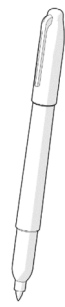

x1

Note: This Bulletin contains only a general description of the products shown. While product uses and performance capabilities are generally described, the products shall not, under any circumstances, be used by untrained or unqualified individuals. The products shall not be used until the product instructions/user manual, which contains detailed information concerning the proper use and care of the products, including any warnings or cautions, have been thoroughly read and understood. Specifications are subject to change without prior notice.

MSA operates in over 40 countries worldwide. To find an MSA office near you, please visit [MSAafety.com/offices](https://www.MSAafety.com/offices).